



RIV 175

Double-acting pneumatic actuator

Tech drawings and tables

DN	Code	H	L	A	KG	P/box
6"	050175000000	330	367	175,5	15,661	1
8"	050175000020	382	380,5	180,5	20,246	1

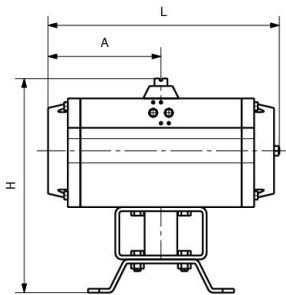

Technical data

Limit	-10°C +80°C
Notes	MINIMUM OPERATING PRESSURE: 5 Bar (70 Psi)
	MAXIMUM OPERATING PRESSURE: 10 Bar (145 Psi)